



T H E C R O W N S T A G E O N E

E L S T R E E S T U D I O S

O N E C O M P O S I T E S E T

F O R T Y I N C A R N A T I O N S

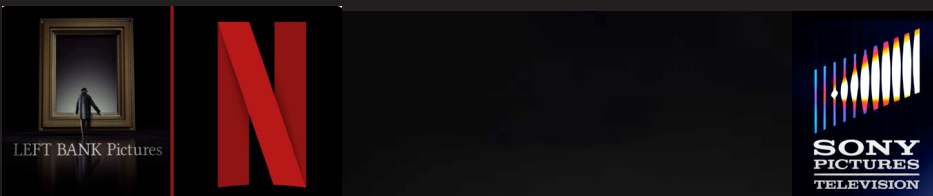

THE CROWN AND SUSTAINABLE DESIGN

There's a healthy philosophy in Italian cuisine: there is no such thing as leftovers, only a never-ending meal. In other words, nothing gets chucked, everything makes a contribution to the next meal and/or the one after. (How else could arancini have become a thing?)

From the beginning we made a decision to apply the never-ending rule to *The Crown*. With up to a dozen different directors using any or all of the sets over time, it was a given that each would seek out their own way to use them. With an average of around 40 sets per episode, 30 of them new to the show, each set was designed to be as futureproof as could be, able to be turned at short notice into whatever later scripts might demand. In a rare case of win-win the creative approach not only went hand-in-hand with the ethical approach, the two became the same approach.

Of course, back in 2014 we didn't know how much future we needed to proof. We threw ourselves into the deep end with something unprecedented: not so much a revamp as a prevamp. Knowing that whatever happened with the commissioning of further seasons we would always need the Queen's private apartments. They were designed in such a way that they could begin life as the Villa Windsor in Paris, then have their windows and our furniture switched to make the channel crossing to Buckingham Palace. The Queen's apartments would then later spend an episode as Diana's Buckingham Palace private apartment. A precedent was set.

Thus in a twist of history, a king who was never crowned would share the Queen's bedroom with a never-to-be future queen, with no-one - until now - the wiser. In another twist, seasons later, Dodi Fayed's fiancé will be living in a chic Parisian apartment that was once Queen Mary's breakfast room, itself having once been a clubhouse at Windsor Polo Ground and much more beside, soon after to become a tartan-rich study in Balmoral. And (tell no-one) no matter who they were or where they were flying to, everyone in *The Crown* went to Stage 6, Elstree Studios, and caught the same plane.

Martin Childs, Production Designer

THE BUCKINGHAM PALACE SET MODEL

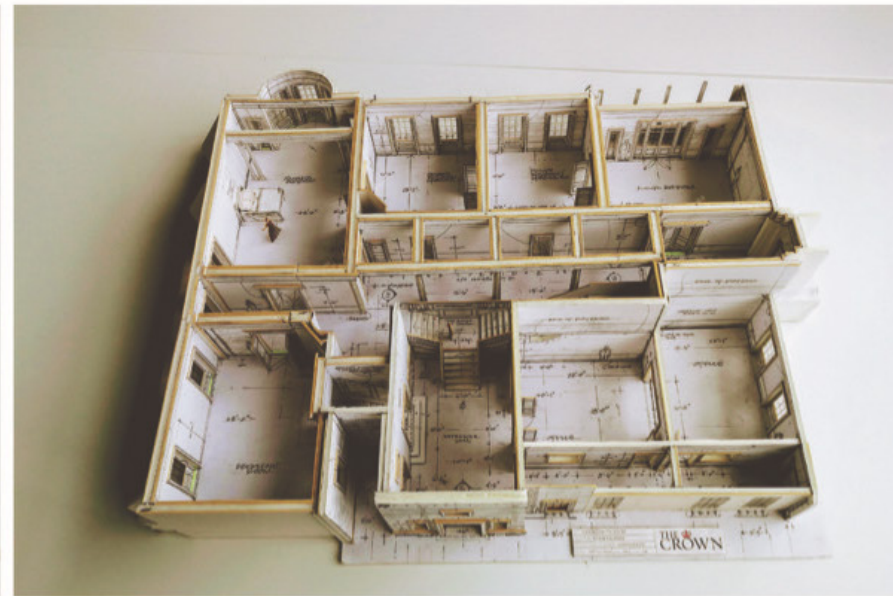
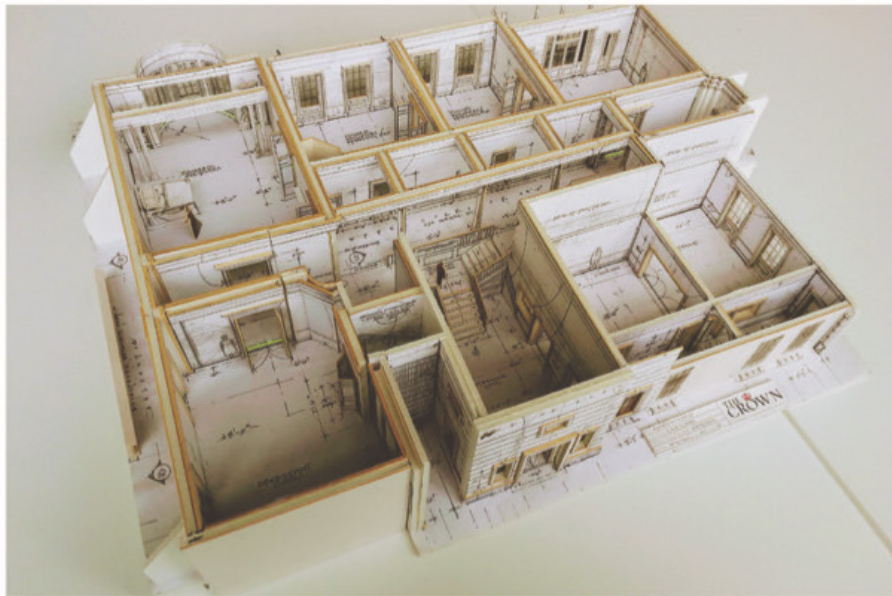

BUCKINGHAM PALACE: A REVAMP

DIANA'S APARTMENT AT BUCKINGHAM PALACE
STAGE ONE REVAMP

HALLWAY
PAINT GREEN AS 'PRINCESS ALICE' LANDING REVAMP



DRESSING ROOM PAINTED THROUGHOUT TBD USING COLOURS
PULLED FROM THE TWO WALLPAPERS

DRAWING ROOM
PAPER AS (SOMETHING LIKE) ABOVE



BEDROOM
PAINTED & PAPERED
IN SHADES
OF WHITE
OFF-WHITE & GOLD

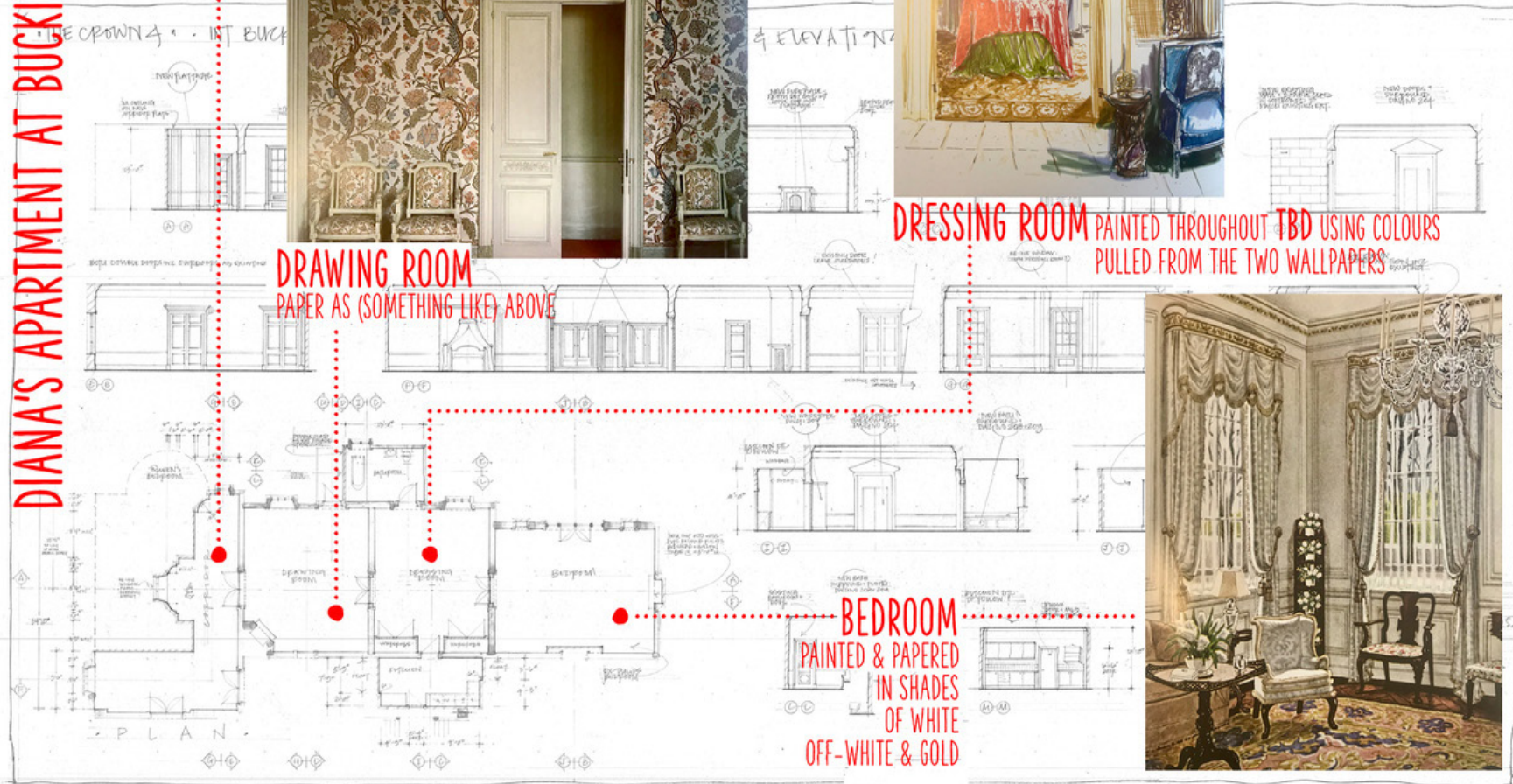

DRESS - STRIKE - REPEAT: RE-USING THE BUILT SPACES



Over the six Seasons of *The Crown*, eight of the original built spaces were turned into 110 different sets.

The Stage 1 Composite Buckingham Palace set alone was revamped over 40 times and the Plane Fuselage was reincarnated 38 times.

The Breakfast Room pictured left became amongst others:



- The Queen's Study Balmoral
- Windsor Polo Club
- The Queen's Private Sitting Room
- Kelly Fisher's Parisian Apartment
- Prince Phillip's Study
- 3 Balmoral Bedrooms
- Queen Mary's Dining Room
- Queen Mother's Clarence House Bedroom
- Villa Windsor Bois de Boulogne
- William's Bedroom at Kensington Palace



REVAMPS

STAGE 1

BP Breakfast Room also became :-

S3	BP Morning Room
S4	BP Drawing Room
S5	1918 Breakfast Room
S6	Kellys Fisher's Apartment - Sitting Room

BP BEDROOM SUITE also became :-

S2	BP Cinema Room
S3	Princess Alice Bedroom
S3	Buckingham Palace, Charles & Anne's Drawing Rm
S4	Diana's Rooms (Filled with letters & flowers)
S5	Balmoral Castle - Dressing Scenes
S6	Charles BP Bedroom
S6	Balmoral Queen's Study
S6	Downing Street - Blair's Drawing Room
S6	Balmoral Cottage (William & Harry's after party)
S6	Buckingham Palace: Chinese Dining Room
S6	Williams BP Bedroom

BBUCKINGHAM PALACE OFFICES also became :-

S2	Stephen Ward's House & Treatment room
S3	Phillip's Study
S3	BP Adeane's Study/Office
S3	Charteris Office
S3	Aberystwyth Uni - Millward's Office
S4	BP Security Room
S5	BP Fellows Office
S5	Kensington Palace - Margaret's Apartment - Bedroom
S5	Kensington Palace - Margaret's Bathroom
S5	William's Room KP
S6	Brenna House - Sardinian Darkroom
S6	Muir's Dark Room
S6	Teenage girl's bedroom
S6	Diana's KP Kitchen

STAGE 7

S2	Cabinet Room
S3	Cabinet Room
S3	Wilson's apartment/study
S3	Heaths Drawing Room
S3	BP Anne's Room
S3	Kensington Palace Dining Room (Margaret's Birthday)
S4	Gatcombe Park- Anne's consevatory
S4	Downing Street Thatchers Study/office
S4	Downing Street Ingham Office (Thatcher's Gov.)
S5	Diana & Charles KP apartment
S5 & 6	Dianas KP apartment

STAGE 6

S4	Downing Street Thatcher's Flat (Bedroom)
S4	Downing Street Thatcher's (Kitchen/drawing room)
S4	Downing Street Thatcher's (Hallway)
S4	Michael Sheas House (Belgravia) Study
S5	Britannia - Royal Corridor & staircase
S5	Britannia - Elizabeth's & Phillip's cabin
S5	Ipatiev Basement 1918
S6	Ritz Hotel - Imperial Suite
S6	Ritz Corridor (to match RAF Halton)

STAGE 5

S3	M15 Interogation Room
S3	Photographer's dark room (s.3 Stamp montage)
S3	BBC's shed at Saint Paul's Cathedral
S3	Garient Moss House- Aberfan
S3	Garaint Moss House (Kitchen with coal stove & tin bath)
S3	Mary Phillips House - Aberfan
S3	Edwards House (downstairs/ Kitchen) - Aberfan
S3	Washington DC Apartment
S3	Washington DC - NBC TV Studio "Meet the Press"
S3	Pantycelyn Uni. Halls - Charles Room
S3	Int Studio, Houston
S3	Int. Television Studios, Apollo Space coverage various (inc BBC)
S3	Int. Television Studio, Election Night various
S3	Int. Tony's Dark Room
S3	Broadlands - Charles Bedroom
S3	Broadstairs House
S4	Thatchers Lux. Hotel Suite (originally in Spain)
S4	Newcastle Radio Studio
S4	ABC Australia make up room
S4	ABC Australia Four Corners Studio
S4	News of Bomb reaches BP Switchboard
S4	Britannia Shea's Cabin
S4	Britannia Charteris Office
S4	Britannia Corridor
S4	Britannia State Drawing Room
S5	Britannia - Dining Room
S5	Britannia - Backstairs & gangways
S5	Britannia - Fellows Cabin/office
S5	Britannia - Tim Lawrence Office
S5	Britannia Staff Areas/ below deck corridors
S5	Desert Island disks recording studio
S6	Kensington Palace - Margaret's Bedroom & Bathroom
S6	Mustique Bathroom - Margaret Scalds her Feet
S6	Mustique Les Jolies - Corridor & Courtyard
S6	Geneva- Airport (Mohamed press statement)
S6	Kate's bedroom in Oak Acre
S6	William's Space Capsule

PLANES (just some !)

S2	De Havilland Dove (Philip Pilots)
S2	Junker (Cecilie's crash)
S3	De Havilland .114 Heron (Wilson/Queen Aberfan)
S3	De Havilland .114 Heron Cockpit (Phillip Aberfan)
S3	Int Plane Queen to Wales Airfield- St Athan (Heron/Dove)
S3	Areoplane (Charteris & Alice)
S3	(BOAC VC 10)first class (T & M to States)
S3	Int Plane (Tony & Margret internal flight to LAX)
S3	Int Private Plane to White House s.3
S3	Arizona Airfield - Private Plane to White House
S3	Big Royal Plane (VC10) Queen to France
S3	Int. VC10 Aircraft Cargo Plane
S4	Australian Airforce (RAF) Boeing - Charles and Di to Oz
S4	Queen's Plane (Queen to Nassau)
S4	Plane Government VC10 (Intercontinental)- Thatcher to Nassau
S5	Royal Aircraft (Charles & Di - Italy)
S5	Flight to Moscow (Penny & Phillip)
S6	Royal Flight (Charles talking to Diana)(Charles with Diana's Sisters)

BP BACKLOT

S3	Port Corchere
S5	Cheshire Bookmakers
S6	Parisian Fabric shop
S6	Exterior Ritz
S3	Exterior Aberfan
S5	Windsor Castle (burnt)

ELSTREE: Other Revamps

S2	The Parkers House
S3	Broadlands - Mountbattens Bathroom
S3	Cardiff Temple of Peace (sfx explosion)
S3	OB Van interior for Investiture
S3	Cambridge Theatre - Charles dressing room
S3	int Peebles, Veitch's Outfitters / cubicle
S4	Words TV Networks (bbc, America, Mexico, Oz Germany, France, Japan, India) 4 x sets, 4 x archive
S4	1947 - Somerville Collage Chemistry Lab - Thatcher
S5	London Tailors Shop (Sydney & Mo, Dodi/Polo kit)
S6	Muir & Brenner Interviews

Some of the (many !) pick up shots reusing sets at Elstree

S4	Literary Agency
S4	Breakfast Room
S4	Prince Andrew Reading paper
S4	Shaes House
S4	Highgrove Charlie having Breakfast
S4	Sonny Ramphals Office
S4	Classiebawn Boot Room
S4	Iceland lodge Int
S4	Atterbury Street- Geofory Homes Bedroom
S4	Harley Street-Margrets Psychiatrists Office
S6	Al Fayed Park Lane Apartment
S6	Balmoral Breakfast Room

SUSTAINABILITY WITHIN THE SET DEC DEPARTMENT: PROPS



The dressing, when not hired, was sourced from Auctions, Antique Shops, Charity shops, Ebay and Etsy. Much of the furniture, drapes etc. was sold onto existing Hire Companies to be recycled through the Film & TV industry. All packaging material used by the Prop Department was recyclable.

Leftbank partnered with **Bonhams** to auction for charity the best, most interesting Props and Costumes. This has been 8 months of work, the proceeds to go to establishing **The National Film School Scholarship** to financially help the next generation of Film Makers.

At the end of Filming - The Production Team, Set Dec and Props Team spent 6 months recycling and rehoming everything - to multiple Charities, Educational charities, Theatre Groups, other TV Productions, Salvage Architectural yards, Textile Recycling.

There was a real commitment on every level to avoid anything going in a skip.

Destinations for the dispersment of the assets included:

- Women's Refuges
- 'Sharing and Giving' Homeless Charities
- Copped Hall Charitable Trust which took all the old books to resell to help restore its Historic Building
- The British Heart Foundation took a large quantity of furniture and small items
- Charity Shops took boxes of china, glassware
- South Thames College Group for Adult and Community Learning, Youth Training Employment and Skills took the spare rolls of fabric and period chairs to learn Upholstery Techniques
- The Questors Theatre in Ealing took fabric stage drapes and furniture for use in future productions
- Seven other Lower Budget Productions were helped by buying from the Prop Stock at 20 -30% of the original cost



COMPANY

British Heart Foundation ~ Finchley North

Gratitude

Cancer Research UK

Bonhams

Authentic Reclamation

Stockyard

Old Times

Soul Deli

Classic Props

Seasons Textiles

Newman's

Farley

Film Med

Aces High

South Thames College Group

Groundwork

Tring Auctions

Criterion Auctions

Bellmans Auctions

Scrap metal guy

Copped Hall Book Trust

Free cycle

Crew Sales

Insomnia

Mandrake

Mr. Loverman

Rakes Progress

Gangs of London

Polite Society

Miss Austen

Airhead

Wedding company

Confidential documents

Elstree Recycling Centre

Fluorescent tube recycling

Pure Energy

Compuhire

Trevor Howsam Boston

Trevor Howsam London

Trading Post

Second Hand Chairs and Tables

Questors Theatre Company

DESCRIPTION

Charity Shop

Local food bank at Elstree

Charity Shop

Auction House

Architectural Salvage company

Prop House

Prop House

Catering company at Elstree Studios

Prop House

Prop House

Prop house

Prop House

Prop House

Prop House

Adult & Community learning

upscales furniture for sale teaching local communities new skills

Auction House

Auction House

Auction House

Scrap metal recycling

Charitable trust

Website to donate items

Props sold to members of the crew

TV Production

TV Production

TV Production

TV Production

TV Production

Low budget film

TV Production

TV Production

Event company

Confidential Waster Shredding & recycling

Business recycling

Audio Visual events company

Prop House

Prop House

Prop House

Prop House

Website to sell second hand tables & chairs

Theatre in Ealing

ITEMS DONATED

Large quantity Furniture

Pillows, sheets, duvets, cushions, household items, dried goods and other kitchen supplies

Bric a brac and household items including framed pictures for sale

Selected furniture and props for resale to the public

fireplaces, bathroom furniture, lights, plaster columns, ironmongery, exterior lighting, large wooden screens, etc

Flags, cushions, lighting, furniture, technology

Vases, ornaments, furniture

Tablecloths, large glass vases, cherub table decorations, bud vases, 100's of pieces of glassware

Large assortment of selected furniture for reuse in the film industry

Drapes, cushions, rolls of fabric, trimmings and fabric accessories

Large selection of lighting donated for reuse in the film industry

Furniture

Old medical equipment

Old plane seats / loose covers/prop make cockpit

Rolls of fabric for student training

Carpet, chairs, settees, vintage beds

Selected furniture

Selected furniture

Selected furniture

Any and all metal split out and recycled

000's of books donated

Used Freecycle to donate remaining pieces of furniture to the local community

Selected furniture and props for resale to the public

Props sold and reused on another production

Props sold and reused on another production

Props sold and reused on another production

Props sold and reused on another production

Props sold and reused on another production

Props sold and reused on another production

Props sold and reused on another production

Props sold and reused on another production

All artificial flowers to reuse for weddings

Paid for confidential paper waste to be shredded and recycled

Paid for paper, cardboard, aerosols, chemicals, paint and plastics to be recycled correctly

Paid for dozens of fluorescent tubes to be correctly recycled as they contain Mercury

Donated all typewriters, vintage to modern TV's, computers, printers, cables, vintage radios, hi-if's

Vintage computers /tv/ tech

Furniture, excess vintage wallpaper, period packaging and tools

Vintage theatre programmes, periodicals, newspapers and magazines

Flags and flag poles

Paid advert to sell large runs of chairs

Large drapes/furniture

WORKING WITH GREENSHOOT & THE GREEN SCREEN PLATFORM



From Season 1 of *The Crown* Left Bank Pictures worked alongside Greenshoot with their Green Screen environmental production platform to develop sustainable best practice.

They helped us focus on elements as diverse as minimal set builds and the reuse of construction materials through to the more considered use of printers, setting them to double-sided printing to minimise paper waste. These are some of the areas where they made an impact:

Net zero fuel and travel accounts Seasons 1-5

The total carbon emissions emitted from fuel and travel during the production of Seasons 1-5 was calculated. The total for each season was then offset through the UN REDD+ programme, which invests in sustainability projects around the world, including the Amazon and the UK.

Net Zero production for Season 6

Left Bank Pictures and *The Crown* Season 6 increased their stakeholder and supply chain engagement over the six seasons, raising commitment to their environmental and sustainability programme. The total carbon emissions emitted for Season 6 will be offset in its entirety leading to the first High-End TV Net Zero Production.

190 new entrants trained through the Equal Access Network

New entrants to production were trained in sustainable production practices, aligned with Left Bank's core principles of sustainable development.

Green Diesel: Fuel and Generators Fit for Purpose

Tim Benson from Smart Power and his team ran an innovative industry pilot scheme on S4 and S5 of *The Crown* to assess fuel efficiency across the production's generators at unit base. This report led to Unit base facilities changing from traditional diesel to Green (HVO) Diesel with a saving of 90% in carbon emissions realised in Season 6.

Innovation in supply chain management over *The Crown* Seasons:

We worked across suppliers and stakeholders of *The Crown*, Seasons 1 - 6 to reduce environmental impacts and support new innovations. Highlights include: new eco flooring, composting programmes, new recycling programmes, new ethical suppliers, and of course the new Green diesel suppliers, reducing the production fuel carbon footprint by 90%.

Waste and Recycling:

Greenshoot supported the supply chain on Left Bank's productions to establish and promote innovation within their processes. By working with key suppliers like Locations One we enabled them to invest in new sustainable programmes like their recycling pod system on *The Crown*. This offered increased efficiency, using a dry mixed recycling programme as the cleanest, most efficient process for film sets that have restricted space and time.

- SINGLE USE PLASTIC WATER BOTTLES SAVED FROM USE: 1.25m
- TRAINED 190 DEPARTMENTAL FIRST ENTRANTS AS GREEN STEWARDS
- NEW INNOVATIONS: ASSISTED IN THE DEVELOPMENT OF GREEN SCREEN
- DIVERTED OVER 1,485 TONNES OF WASTE FROM LANDFILL THROUGH WASTE TO ENERGY AND RECYCLING PROGRAMMES.
- RUNNING A ZERO WASTE TO LANDFILL POLICY.
- SWITCH-OFF ENERGY REDUCTION CAMPAIGNS ON SET.
- VEHICLE NO IDLING POLICY.
- BANNED ALL POLYSTYRENE FROM CATERING (CARCINOGENIC/NON BIODEGRADABLE)
- INTRODUCED MEAT FREE MONDAYS AND DAILY VEGETARIAN AND VEGAN MEAL OPTIONS.
- WORKED WITH CATERING TO REVIEW FOOD MILES, PROMOTING BUYING LOCALLY.
- INNOVATIONS IN CONSTRUCTING SETS - USE OF FSC WOOD

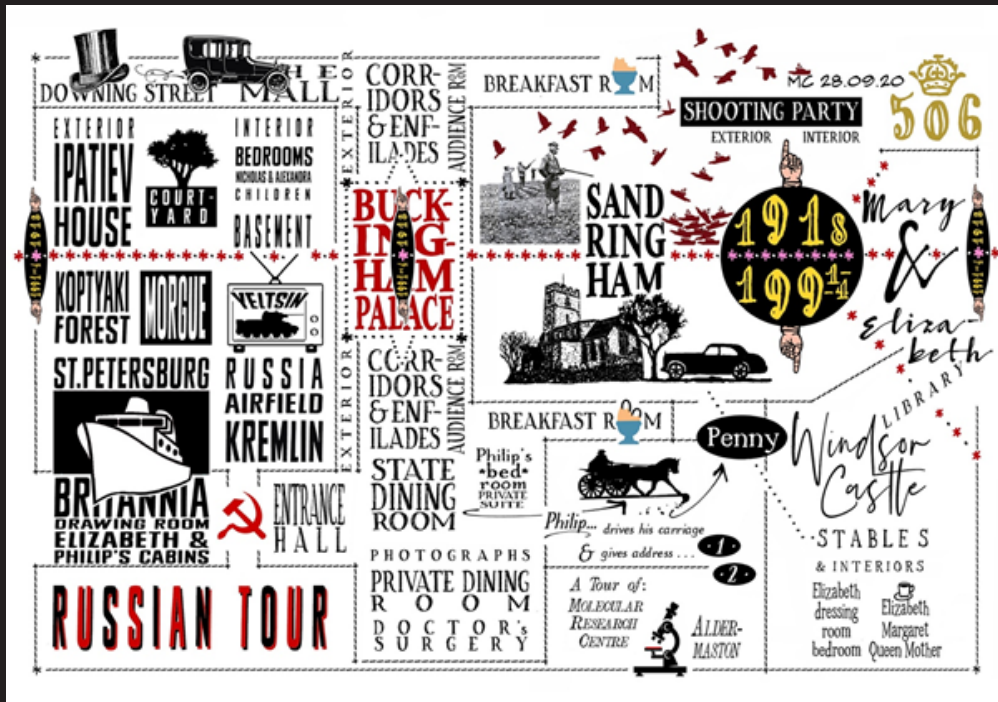

The Crown Sustainability Champions

Martin Childs - Production Designer
 Mark Ragget - Supervising Art Director
 Alison Harvey - Series Set Decorator
 Neal Kirke - Assistant Prop Master
 Alison Cardy - Production Buyer

Hilary Benson - Director of Production
 Michael Casey - Producer
 Eve Swannell - Co-Producer
 Carrie Banner - Supervising Production Manager
 Becki Warren - Key Production Co-Ordinator
 Georgina Brown - Commercial Manager

Jon Wardle, Director of the National Film and Television School, said: “We are thrilled that future talent flowing from the National Film and Television School (NFTS) will benefit from the exceptional items generously donated by Left Bank Pictures and *The Crown*. Since its inception, the dedicated craftsmanship of over 60 NFTS alumni has been pivotal in bringing such an iconic series to life. The proceeds from the auction will play a crucial role in supporting life-changing scholarships, ensuring the next generation of film and television makers are given the opportunity to benefit from our world-renowned training, paying forward *The Crown*’s legacy for many years to come.”

Andy Harries, Chief Executive of Left Bank Pictures and Executive Producer of *The Crown*, added: “It has been a privilege for me and all at Left Bank Pictures to have been at the heart of *The Crown*. Its huge global success has much to do with working with the best creative and production talent in this country and we want to invest the proceeds of this magnificent auction into the next generation of film and TV talent. The NFTS has been part of *The Crown*’s history from the start with many of its graduates contributing to the production of the show over the years. I have long admired the ethos and training of the school and supported it personally. So I am thrilled that the legacy of *The Crown* will be to provide so much financial support for so many students at the NFTS over the next few decades. With their unrivalled knowledge and expertise in Film and Entertainment memorabilia, Bonhams was the sole choice of partners for us. Their specialists’ excitement, vision and passion for *The Crown* Auction was evident from the start.”